

Islington Road

SOUTHVILLE

APPROXIMATE FLOOR AREA
90.9 SQM / 979 SQFT



GROUND FLOOR
544 sq.ft. (50.6 sq.m.) approx.

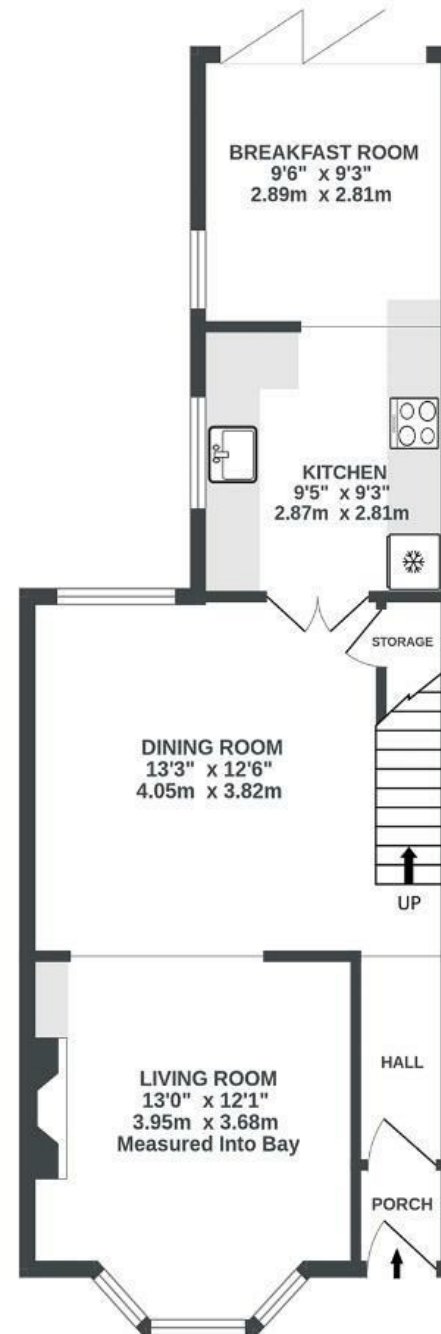

1ST FLOOR
435 sq.ft. (40.4 sq.m.) approx.

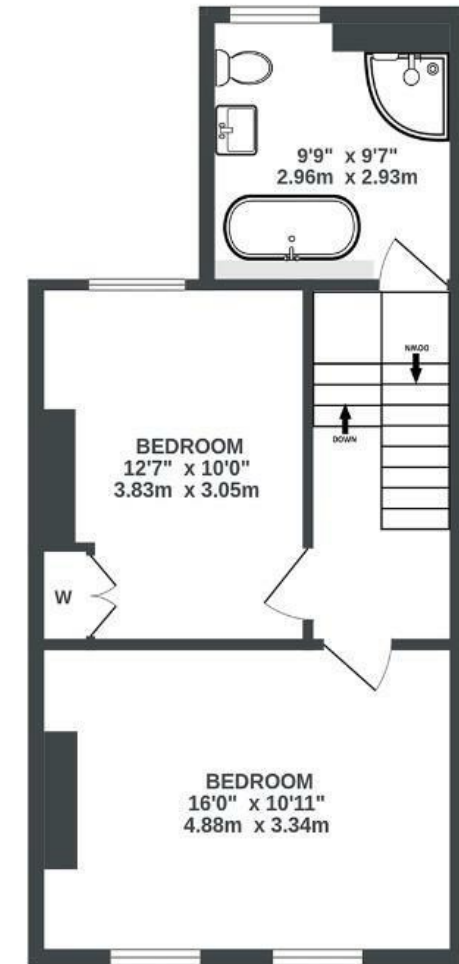

Illustrations are for reference purposes only, measurements are approximate, not to scale.

Boardwalk

Islington Road

SOUTHVILLE, BRISTOL



£550,000



2 Bedrooms



BS3 1PZ



1 Bathrooms

"I've absolutely loved living here in my little city haven. The house is so peaceful—perfect for chilling out all year round. The garden gets lovely sunshine, the kitchen is bright and airy, and in winter the living room feels so cosy and inviting. It's also a perfect house for hosting, and I always get so many compliments whenever I invite people over. I've really enjoyed being right between Whapping Wharf and North Street, with all those great restaurants and cafes just steps away. The road feels like a close-knit little community, with supportive whatsapp group, which I've really appreciated. I'm definitely going to miss the freestanding bath and being able to walk to everything the city has to offer."

